



WESTERN MICHIGAN UNIVERSITY

— Homer Stryker M.D. —

SCHOOL OF MEDICINE

Celebrate

September 18, 2014



Welcome

Thank you for coming to the grand opening celebration of Western Michigan University Homer Stryker M.D. School of Medicine. Today we celebrate and introduce you to our inaugural class of outstanding medical students. We welcome you into our newly renovated and expanded medical education facility on the W.E. Upjohn M.D. Campus. And, we show our appreciation for your continued engagement, support, and interest in Southwest Michigan's new medical school.

A handwritten signature in black ink that reads "Hal B. Jenson". The signature is written in a cursive, flowing style.

Hal B. Jenson, MD, MBA

Schedule of Events

4:00 p.m. Doors open

Guests are asked to be seated and self-guided tours will begin after the ceremony.

4:30 p.m. Ceremony

5:30 p.m. Self-guided tours of lower level, first and second floors

Speakers

A. Lorris Betz, MD, PhD

Senior Vice President Emeritus of Health Sciences,
University of Utah

John M. Dunn, EdD

President, Western Michigan University

Hal B. Jenson, MD, MBA

Dean, WMU Homer Stryker M.D. School of Medicine

Frank J. Sardone

President & CEO, Bronson Healthcare

Paul A. Spaude

President & CEO, Borgess Health

Keynote

A. Lorris Betz, MD, PhD

Senior Vice President Emeritus
of Health Sciences,
University of Utah

Chair of the Board of Directors,
Association of American Medical Colleges



Dr. A. Lorris Betz began his term at the University of Utah in June 1999 as Senior Vice President of Health Sciences, Dean of the School of Medicine, and Chief Executive Officer of University of Utah Health Care. He holds faculty appointments in the department of Pediatrics, and the department of Neurobiology and Anatomy, and he twice served as Interim President of the University. Following his retirement in May 2012, Dr. Betz was named Senior Vice President Emeritus of Health Sciences and he was awarded an honorary Doctor of Science degree by the University. Dr. Betz currently serves as Chair of the Board of the Association of American Medical Colleges.



Class Profile

This exceptional group of 54 students was selected from an applicant pool of more than 3,500. The inaugural class has 24 women and 30 men from 14 states, including 23 students from Michigan and 15 from California. They represent 35 colleges and universities from across the country. Three students are graduates of Western Michigan University and two are from Kalamazoo College. One member of the class attended college as a Kalamazoo Promise scholarship recipient.

Milestones

- Oct. 25, 2007 During Academic Convocation/State of the University Address, President John M. Dunn announced that WMU will engage in discussion about the possibility and potential of a medical school at WMU.
- Jan. 25, 2011 Hal B. Jenson, MD, MBA from Tufts University School of Medicine is named founding dean.
- Mar. 22, 2011 A \$100 million cash gift, the largest ever made to a Michigan college or university, is made to WMU and served as the foundational funding for the medical school.
- Dec. 8, 2011 At the WMU Board of Trustees meeting, William U. Parfet, the chairman and chief executive officer of MPI Research and the great-grandson of W.E. Upjohn, MD, donated to WMU a 330,000 sq. ft. building located in downtown Kalamazoo that serves as the home of the medical school.
- Oct. 12, 2012 During the groundbreaking ceremony at the site of the new medical school on the W.E. Upjohn M.D. Campus, Dean Hal Jenson announced that the medical school was granted preliminary accreditation from the Liaison Committee on Medical Education, permitting the new medical school to move forward to recruit its first class of medical students.
- Mar. 11, 2014 Western Michigan University announced the new medical school will be named in honor of Dr. Homer Stryker, a WMU alumnus and founder of Stryker Corporation. The naming recognized the donors of the 2011 foundational \$100 million gift, Stryker's granddaughter, Ronda Stryker, and her husband William Johnston, a WMU trustee. WMU also announced a separate corporate gift from Stryker Corporation for the medical school that bears its founder's name.
- Aug. 18, 2014 The inaugural medical school class of 54 students arrived and began the CLEAR curriculum to prepare exceptional clinicians, leaders, educators, advocates, and researchers of tomorrow.



VIRTUAL HOSPITAL

LABOR & DELIVERY

PEDIATRICS

INTENSIVE CARE

OPERATING ROOM

TRAUMA & EMERGENCY

HOSPITAL &
DEBRIEFING ROOMS

LOWER LEVEL

ATRIUM

PROCEDURE LAB A

PROCEDURE LAB B

ULTRASONOGRAPHY

CLASSROOM S1

CLASSROOM S2

SIMULATION STAFF OFFICES

VIRTUAL CLINIC

PATIENT STAGING ROOM

ENDOSCOPY, LAPAROSCOPY
& ARTHROSCOPY

FACILITIES STAFF OFFICES

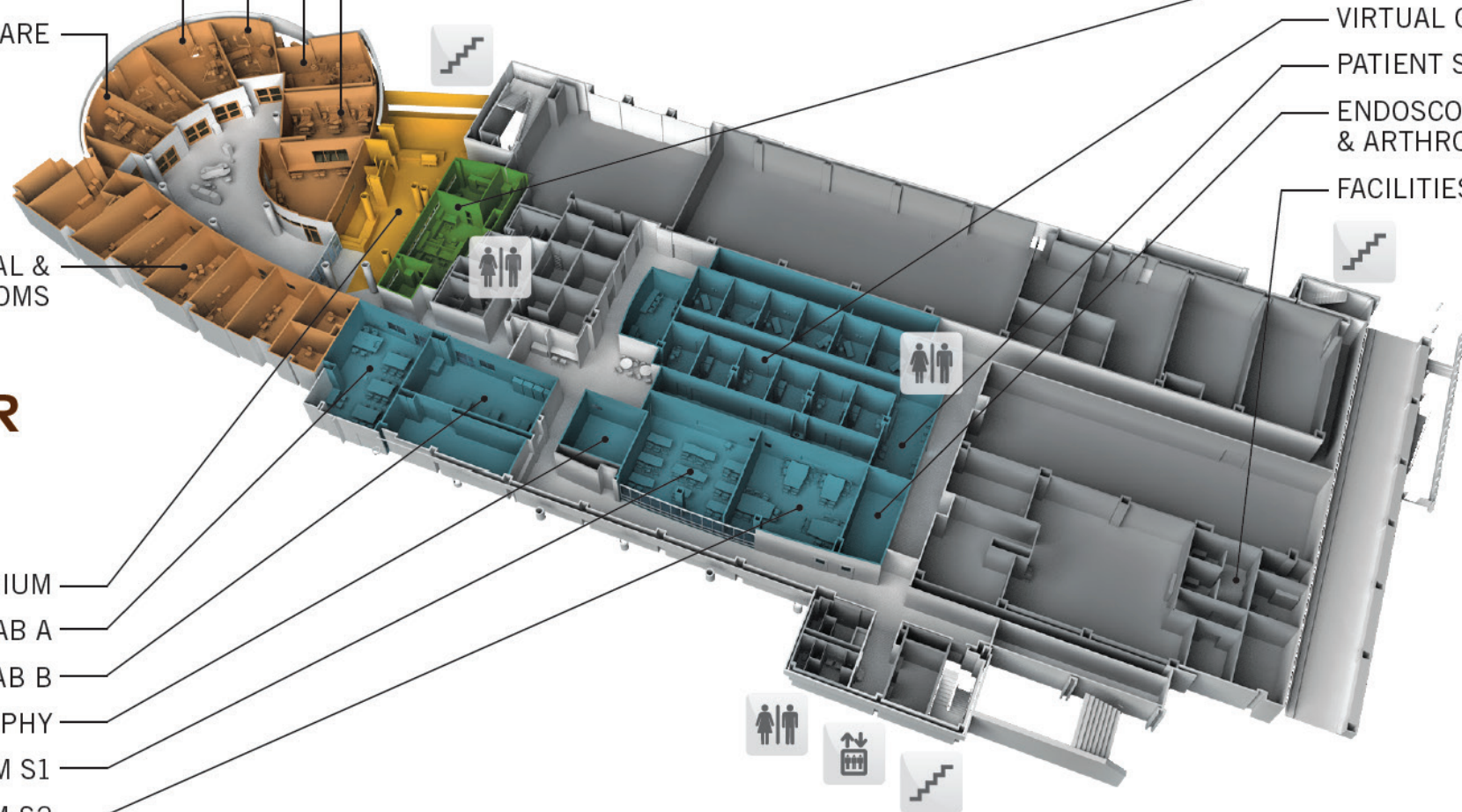

Lower LEVEL

SIMULATION CENTER

The Simulation Center is the largest regional academic simulation center in southwest Michigan. Realistic simulated medical scenarios are utilized to allow learners to practice recognizing essential data within complex situations, to initiate timely treatment, and to coordinate medical care as teams.

- More than 24,000 sq. ft. designed with a virtual hospital and an ambulatory clinic.
- Virtual hospital with eight simulation rooms and a 20-seat control room.
- Virtual clinic with 12 patient exam rooms, patient staging room, and a 12-seat control room.
- Endoscopy, laparoscopy, arthroscopy ultrasonography space and equipment.



FIRST FLOOR

PUBLIC ENTRANCE

TBL HALL 1
CLASSROOM 110
CLASSROOM 111
GROUP ROOMS

FITNESS CENTER
FITNESS STUDIO
CLASSROOM 112
AUDITORIUM
GROUP ROOMS

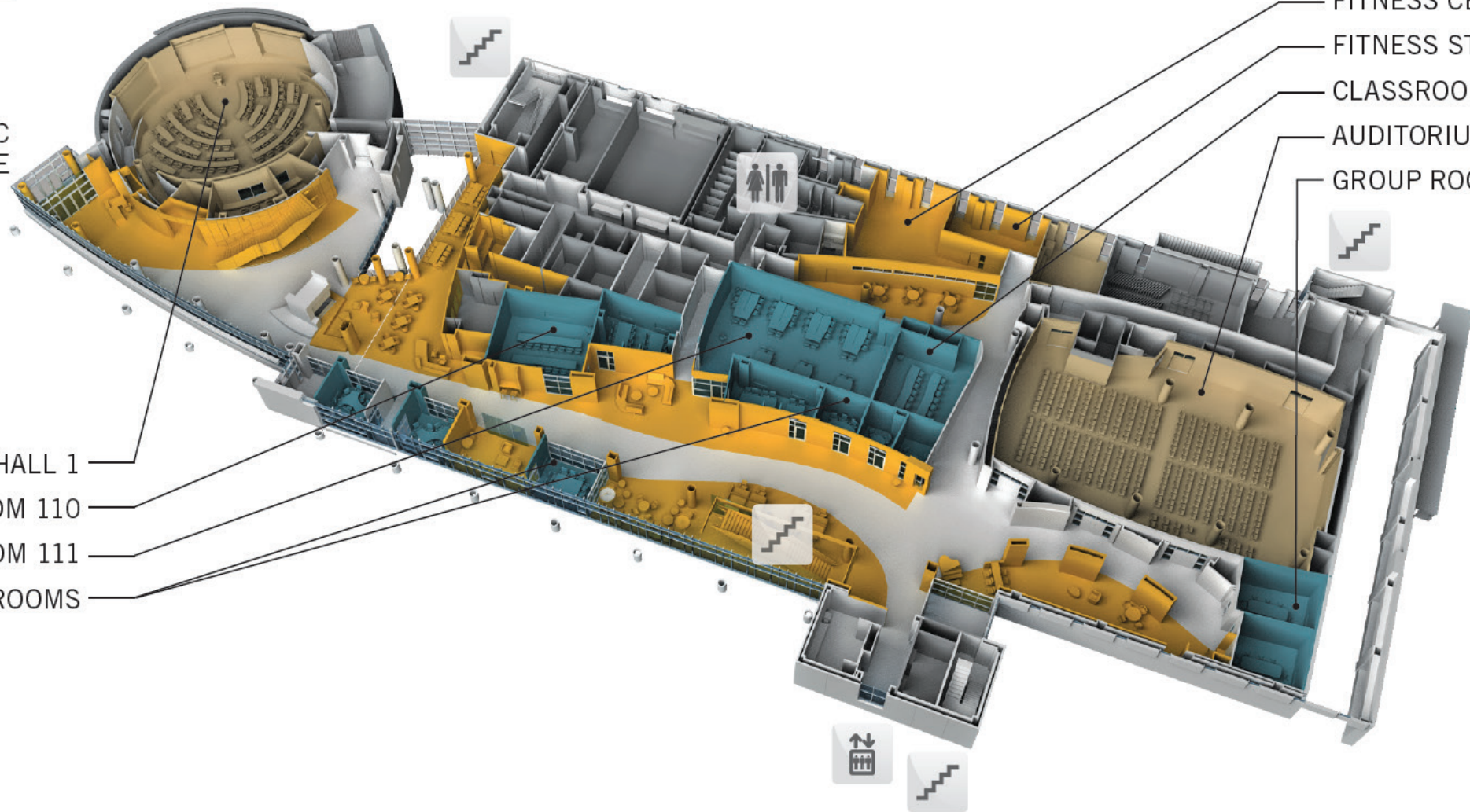

First FLOOR

TEAM-BASED LEARNING (TBL)

At the medical school, learning is a shared activity using contemporary technologies and instructional strategies that focus on problem-solving in a stimulating team-oriented learning environment.

- TBL hall 1 is a 90-seat tiered space designed to support large and small group learning.
- TBL observation room for presenters or observers.
- Large and small classrooms that support various group sizes.
- 12 group rooms to accommodate groups of 4-12.
- 340-seat auditorium and event support space.
- Open café seating area, fireplace, and other soft seating for individuals and informal groups.
- Fitness center and fitness studio.



SECOND FLOOR

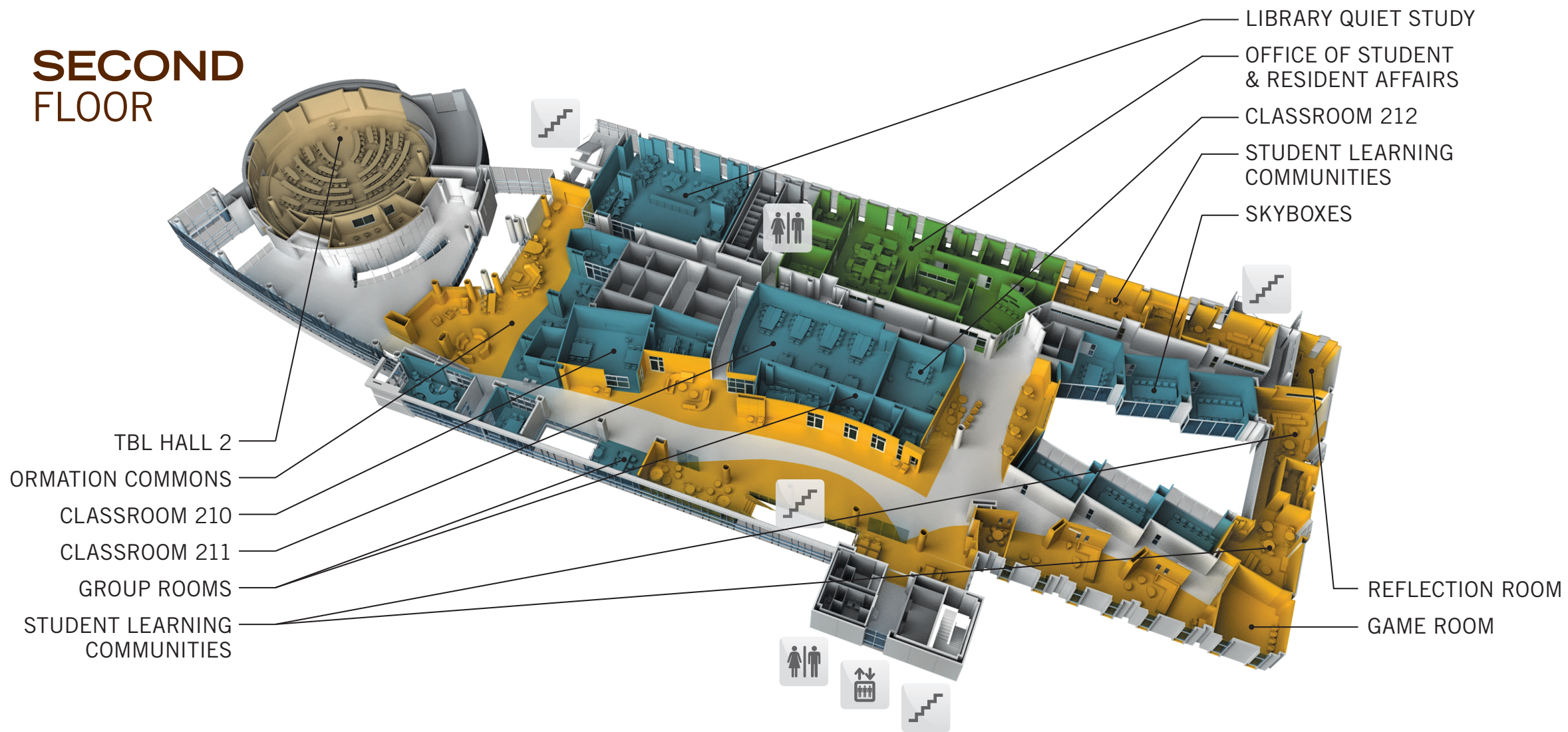

Second FLOOR

LEARNING COMMUNITIES

Students are organized as members of learning communities, which are established to enhance and maximize student learning by promoting professional and social interactions among and between classes.

- Second level has classrooms and group rooms similar to first level.
- Six skyboxes overlook the auditorium to expand space through linked audiovisual technology.
- Information commons and library.
- Student commons composed of four separate learning communities complete with kitchens, lockers, and social space.
- Game room and a reflection room.
- Office of Student and Resident Affairs.



Other FLOORS

THIRD FLOOR

Office of the Dean, faculty offices and collegium, media room, Department of Pathology and Office of the Medical Examiner, Information Technology, and support services.

FOURTH, FIFTH AND SIXTH FLOORS

To be redeveloped in the future to support the medical school's research strategy.

SEVENTH FLOOR

Office of the Medical Examiner and Forensic Pathology, more than 30,000 sq. ft. with two autopsy rooms, isolation autopsy room, law enforcement and family viewing, supporting infrastructure, anatomy and advanced anatomy labs, and a multi-purpose lab.



Thank You

- Alamo Draffhouse Cinema
- Arts Council of Greater Kalamazoo
D. Neil Bremmer, Executive Director and Beth McCann, Deputy Director for Programs and External Communications
- Bronco Marching Band
David Montgomery, Director
- Discover Kalamazoo & Downtown Kalamazoo Incorporated
- Kalamazoo Symphony Orchestra
Peter H. Gistelinck, Executive Director
- Grand Opening Ceremony Underwriters
Diekema Hamann
Mopec
Old National Bank
The S/L/A/M Collaborative
Walbridge



Mission

To educate and inspire lifelong learners to be exceptional clinicians, leaders, educators, advocates, and researchers of tomorrow.

Vision

To be distinguished as a leader among medical schools through community collaboration in medical education, patient care, research, and service.

Values

We achieve excellence by:

- Promoting innovation and lifelong learning
- Acting with integrity and professionalism
- Demonstrating leadership, teamwork, and collaboration
- Showing compassion for all, and
- Valuing inclusiveness and diversity.



STRYKER

HOMER HARTMAN STRYKER, M.D.

1884 - 1980

ORTHOPAEDIC SURGEON
MEDICAL DEVICE INNOVATOR
BUSINESSMAN AND FOUNDER OF
THE STRYKER COMPANY
TEACHER, COACH, AND ATHLETE
PHILANTHROPIST

BUILDING ON THE LEGACY OF
INNOVATION
DISCOVERY AND
ENTREPRENEURSHIP
IN KALAMAZOO

WESTERN MICHIGAN UNIVERSITY
HOMER STRYKER M.D. SCHOOL OF MEDICINE
IS NAMED IN HONOR OF DR. STRYKER
TO RECOGNIZE HIS CONTRIBUTION TO
MEDICINE, MEDICAL RESEARCH,
INNOVATIVE PRODUCTS, AND SERVICE
TO IMPROVE PATIENT OUTCOMES.

THE MEDICAL SCHOOL'S FACILITY ON THE
W.E. UPJOHN M.D. CAMPUS HAS ITS ROOTS
IN LIFE SCIENCE RESEARCH AND DISCOVERY.
THE PROPERTY WAS THE FIRST PIECE OF LAND
DR. UPJOHN PURCHASED IN KALAMAZOO
TO START THE UPJOHN COMPANY.



UPJOHN

WILLIAM ERASTUS UPJOHN, M.D.

1852 - 1931

PHYSICIAN
PHARMACEUTICAL INNOVATOR
BUSINESSMAN AND FOUNDER OF
THE UPJOHN COMPANY
COMMUNITY LEADER
PHILANTHROPIST



Community Open House

Saturday, September 20, 2014
10 a.m. – 2 p.m.

No RSVP required | For questions, call 269.337.4500



1000 Oakland Drive • Kalamazoo, MI 49008-8000 • med.wmich.edu